

# OUTDOOR PAR

The Kupo CDM Outdoor Par is designed for portable or permanent installation in wet location with IP65 rating for use with CDM 150W lamps. The housing is constructed of die-casting aluminum for maximum durability and lightweight. Notches on housing gives better heat ventilation. The die-casting CDM box is designed for fitting major brands of HID ballast; lamp and ballast change is easy by screw driver. The front transparent safety lens is made of 5.8mm thickness tempered glass for maximum strength. There will be an inside lens giving light different effect, available in wide, medium and focus beam angle.



1. Notches on housing makes ventilation better
2. Die-Casting CDM Box is feasible for major brands of HID ballast
3. Changable lens gives flood, wide and narrow beam angle
4. Silicon rubber ring is inserted to provide excellent water proof
5. Detachable rear housing for lamp changing friendly





# OUTDOOR PAR

## WP-CDM150

Standard WP-CDM150 comes with die-casting CDM Box, IP65, with Philips HID-Prima Vision Electronic Ballast with 100cm 3/1.5mmsq VDE cable. CDM box inside dimension is 150 (L) x 94 (W) x 35 (H) mm.

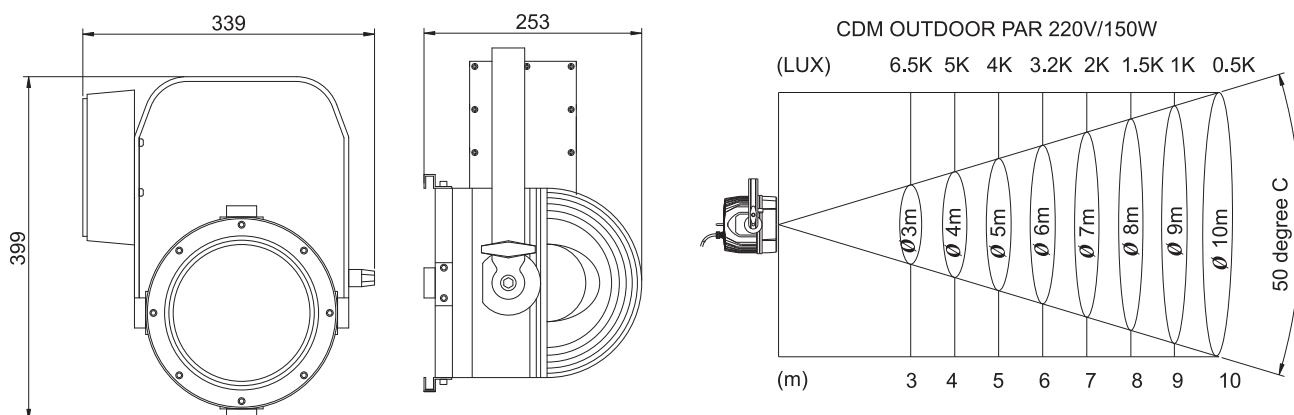

## Photometric Data with different lens



Wide Lens

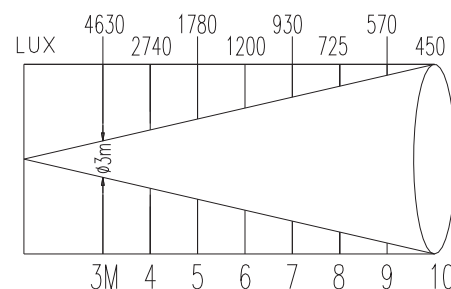

Medium Lens

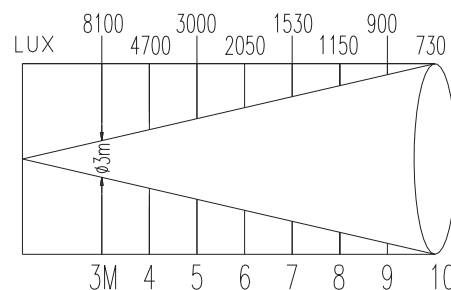

Focus Lens

