



User Manual: Squared Funky Bee 19x10W Battery + W-DMX

10. Maintenance and cleaning

It is absolutely essential that the fixture is kept clean and that dust, dirt and smoke-fluid residues must not build up on or within the fixture. Otherwise, the fixture's light-output will be significantly reduced. Regular cleaning will not only ensure the maximum light-output, but will also allow the fixture to function reliably throughout its life. A soft lint-free cloth moistened with any good glass cleaning fluid is recommended, under no circumstances should alcohol or solvents be used!

DANGER !
Disconnect from the mains before starting any
maintenance work

The front objective lens will require weekly cleaning as smoke-fluid tends to building up residues, reducing the light-output very quickly. The cooling-fans should be cleaned monthly.

The interior of the fixture should be cleaned at least annually using a vacuum-cleaner or an air-jet. Dichroic colour filters, CMY lamellas, gobo and graphic wheels and the internal lenses should be cleaned monthly. Remove dust and dirt from the fans and cooling vents using a soft brush and vacuum-cleaner.

Important! Check the air filters periodically and clean before they become clogged!

Clean two air filters placed in the fixture's covers and two in the fixture base. Use a vacuum cleaner, compressed air or you can wash them and put back dry.

After replacing the air filters, reset the elapsed time counter in the menu "Information" (Information--->Air Filters--->Elapsed Time).

Replacing the fuse. Before replacing the fuse, unplug mains lead.

- 1) Remove the fuse holder on the rear panel of the base with a fitting screwdriver from the housing (anti-clockwise).
- 2) Remove the old fuse from the fuse holder.
- 3) Install the new fuse in the fuse holder (only the same type and rating).
- 4) Replace the fuse holder in the housing and fix it.

Squareled Funky Bee 19X10W

RGBW

Battery + W-DMX

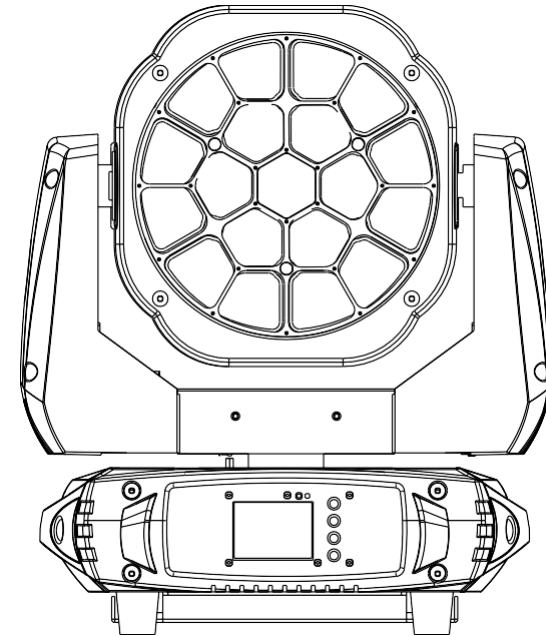

Version 1.0

USER MANUAL

- Be sure to read the USER MANUAL carefully before using this product. Be
- sure to keep the USER MANUAL properly for future needs.

1. Safety instructions

Thank you for choosing our Squareled Funky Bee. FOR YOUR OWN SAFETY, PLEASE READ THIS USER MANUAL CAREFULLY

BEFORE YOU INITIAL START - UP!

CAUTION!
Be careful with your operations.
With a high voltage you can suffer a dangerous electric shock when touching the wires!

This device has left our premises in absolutely perfect condition. In order to maintain this condition and to ensure a safe operation, it is absolutely necessary for the user to follow the safety instructions and warning notes written in this manual.

CAUTION!
Keep this device away from rain and moisture! Unplug mains lead before opening the housing!

Important:

The manufacturer will not accept liability for any resulting damages caused by the non-observance of this manual or any unauthorized modification to the device.

Please consider that damages caused by manual modifications to the device are not subject to warranty.

During the operation the housing becomes hot). Allow the fixture to cool approximately 20 minutes prior to manipulate with it.

Make sure that the available voltage is not higher than stated on the rear panel.

WARNING! This unit does not contain an ON/OFF switch. Always disconnect power input cable to completely remove power from unit when not in use or before cleaning or servicing the fixture.

Make sure that the power-cord is never crimped or damaged by sharp edges. Check the device and the power-cord from time to time.

Always disconnect from the mains, when the device is not in use or before cleaning it. Only handle the power-cord by the plug. Never pull out the plug by tugging the power cord.

This device falls under protection class I. Therefore it is essential to connect the yellow/green conductor to earth.

The electric connection, repairs and servicing must be carried out by a qualified employee. Do not connect this device to a dimmer pack.

Do not switch the fixture on and off in short intervals as this would reduce the lamp's life.

During the initial start-up some smoke or smell may arise. This is a normal process and does not necessarily mean that the device is defective.

Do not touch the device's housing bare hands during its operation (housing becomes hot)! For replacement use lamps and fuses of same type and rating only.

CAUTION ! EYE DAMAGES !
Avoid looking directly into the light source
(meant especially for epileptics) !

		71	75		Red in Pixel 14
			0..255		Red in pixel 14 saturation control (0-100%)
		72	76		Green in pixel 14
			0..255		Green in pixel 14 saturation control(0-100%)
		73	77		Blue in pixel 14
			0..255		Blue in pixel 14 saturation control(0-100%)
		74	78		White in pixel 14
			0..255		White in pixel 14 saturation control(0-100%)
		75	79		Red in Pixel 15
			0..255		White in pixel 15 saturation control (0-100%)
		76	80		Green in pixel 15
			0..255		Green in pixel 15 saturation control(0-100%)
		77	81		Blue in pixel 15
			0..255		Blue in pixel 15 saturation control(0-100%)
		78	82		White in pixel 15
			0..255		White in pixel 15 saturation control(0-100%)
		79	83		Red in Pixel 16
			0..255		White in pixel 16 saturation control (0-100%)
		80	84		Green in pixel 16
			0..255		Green in pixel 16 saturation control(0-100%)
		81	85		Blue in pixel 16
			0..255		Blue in pixel 16 saturation control(0-100%)
		82	86		White in pixel 16
			0..255		White in pixel 16 saturation control(0-100%)
		83	87		Red in Pixel 17
			0..255		White in pixel 17 saturation control (0-100%)
		84	88		Green in pixel 17
			0..255		Green in pixel 17 saturation control(0-100%)
		85	89		Blue in pixel 17
			0..255		Blue in pixel 17 saturation control(0-100%)
		86	90		White in pixel 17
			0..255		White in pixel 17 saturation control(0-100%)
		87	91		Red in Pixel 18
			0..255		Red in pixel 18 saturation control (0-100%)
		88	92		Green in Pixel 18
			0..255		Green in pixel 18 saturation control (0-100%)
		89	93		Blue in Pixel 18
			0..255		Blue in pixel 18 saturation control(0-100%)
		90	94		White in pixel 18
			0..255		White in pixel 18 saturation control(0-100%)
		91	95		Red in pixel 19
			0..255		Red in pixel 19 saturation control(0-100%)
		92	96		Green in pixel 19
			0..255		Green in pixel 19 saturation control(0-100%)
		93	97		Blue in pixel 19
			0..255		Blue in pixel 19 saturation control(0-100%)
		94	98		White in pixel 19
			0..255		White in pixel 19 saturation control(0-100%)
23	17	95	99		Special function
				0..19	No function
				20..29	No function
				30..39	No function
				40..79	No function
				80..89	All Motor reset
				90..94	SCAN Motor Reset
				95..99	Focus Motor Reset
				100..119	Internalprogram 1
				120..139	Internalprogram 2
				140..159	Internalprogram 3
				160..179	Internalprogram 4
				180..199	Internalprogram 5
				200..219	Internalprogram 6
				220..239	Internalprogram 7
				240..255	InternalSound program 1

		41	45		Blue in pixel 6
				0..255	Blue in pixel 6 saturation control(0-100%)
		42	46		White in pixel 6
				0..255	White in pixel 6 saturation control(0-100%)
		43	47		Red in Pixel 7
				0..255	White in pixel 7 saturation control (0-100%)
		44	48		Green in pixel 7
				0..255	Green in pixel 7 saturation control(0-100%)
		45	49		Blue in pixel 7
				0..255	Blue in pixel 7 saturation control(0-100%)
		46	50		White in pixel 7
				0..255	White in pixel 7 saturation control(0-100%)
		47	51		Red in Pixel 8
				0..255	Red in pixel 8 saturation control (0-100%)
		48	52		Green in Pixel 8
				0..255	Green in pixel 8 saturation control (0-100%)
		49	53		Blue in Pixel 8
				0..255	Blue in pixel 8 saturation control(0-100%)
		50	54		White in pixel 8
				0..255	White in pixel 8 saturation control(0-100%)
		51	55		Red in pixel 9
				0..255	Red in pixel 9 saturation control(0-100%)
		52	56		Green in pixel 9
				0..255	Green in pixel 9 saturation control(0-100%)
		53	57		Blue in pixel 9
				0..255	Blue in pixel 9 saturation control(0-100%)
		54	58		White in pixel 9
				0..255	White in pixel 9 saturation control(0-100%)
		55	59		Red in Pixel 10
				0..255	Red in pixel 10 saturation control (0-100%)
		56	60		Green in pixel 10
				0..255	Green in pixel 10 saturation control(0-100%)
		57	61		Blue in pixel 10
				0..255	Blue in pixel 10 saturation control(0-100%)
		58	62		White in pixel 10
				0..255	White in pixel 10 saturation control(0-100%)
		59	63		Red in Pixel 11
				0..255	Red in pixel 11 saturation control (0-100%)
		60	64		Green in Pixel 11
				0..255	Green in pixel 11 saturation control (0-100%)
		61	65		Blue in Pixel 11
				0..255	Blue in pixel 11 saturation control(0-100%)
		62	66		White in pixel 11
				0..255	White in pixel 11 saturation control(0-100%)
		63	67		Red in pixel 12
				0..255	Red in pixel 12 saturation control(0-100%)
		64	68		Green in pixel 12
				0..255	Green in pixel 12 saturation control(0-100%)
		65	69		Blue in pixel 12
				0..255	Blue in pixel 12 saturation control(0-100%)
		66	70		White in pixel 12
				0..255	White in pixel 12 saturation control(0-100%)
		67	71		Red in Pixel 13
				0..255	Red in pixel 13 saturation control (0-100%)
		68	72		Green in pixel 13
				0..255	Green in pixel 13 saturation control(0-100%)
		69	73		Blue in pixel 13
				0..255	Blue in pixel 13 saturation control(0-100%)
		70	74		White in pixel 13
				0..255	White in pixel 13 saturation control(0-100%)

2. UNPACKING

Squareled Funky Bee adopts a 10W white LED lamp which features high brightness and stability. Please carefully unpack it when you receive the fixture and check whether it is damaged during the transportation. And please check whether the following items are included inside the box:

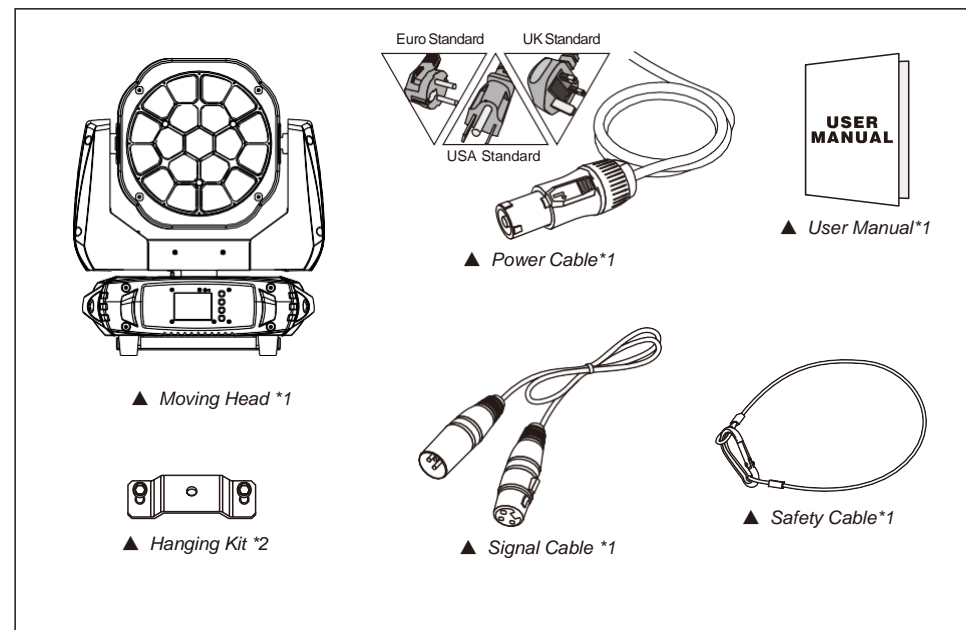

Squareled Funky Bee is made of a new type of high temperature strength of engineering plastics and cast aluminum casing with nice outlook. The fixture is designed and manufactured strictly following CE standards, complying with international standard DMX512 protocol. It's available independently controlled and linkable with each other for operation. And it is applicable for large-scale live performances, theater, studio, nightclubs and discos.

This manual covers the important information on installation and applications. Meanwhile, please keep this manual well for future needs.

3. TECHNICAL INFORMATION

Light Source

nLamp: 19pcs*10W 4-IN-1 RGBW LEDS
nLife span: 50000 hours
nColor: RGBW

Optics

nZoom angle: 6°-60°
nImproved optics and flat beam field

Power Supply

nPower supply: Battery or AC mains
nInput Voltage: AC90-260V 50/60Hz
nPower Consumption: State of charge 280W; non-charged state: 215W

Battery

nBattery type: Lithium iron
nBattery charge time: 0% to 100% charge 5.5 hours,
nMax-endurance: 8 hours (Full power), 12 hours (built-in program)
nTemperature detection function : (-20 °C to 45 °C)
nBattery protection: Battery short circuit protection, over current protection, overflow charging
nCharging mode: When connected to mains and power is insufficient, battery will be charged automatically.
nSupport battery extension.

Control

nControl Signal: DMX512, master-slave and sound activated, auto operation or wireless
nSound control with sensitivity adjustment
Control Channel: 23/17/95/99 DMX channels USITT DMX-512
nDMX recorder and function integrated

Movement

n630° /540° /360° PAN and 270°/180° /90° TILT movement optional
nSmooth and precise resolution for PAN/TILT movement
nScan position memory, auto preposition after unexpected movement.
nPAN/TILT reversible advantage
nPAN/TILT calibration available

Working Environment

n-20°C-45°C max ambient temperature
nConstant temperature readout and management function.
nProtection Rating : IP 20

Construction & Weight

nDimensions: 41*27*48.6(cm) nPacking Dimensions: 50*34*60(cm) nNet Weight: nGross Weight: 22 kgs

Features

nABS die-cast plastic cover with Aluminium structure
nEach pixel controllable individually
nColor temperature Liner up and down in 2700-8000K
n8/16 bit smooth and precise resolution for PAN/TILT movement
nAuto preposition after unexpected movement
nFast, smooth and quiet motorized zoom with 6°-60° range
nEven, soft edge and pure color mixing coverage
nPixel patterning macro effects
nPetal-like micro beam effect
nBuilt-in running programs
nBuilt-in colour and graphic programs
nFlicker free sources management
nAuto re-position after unexpected movement
n0-100% Linear LED dimmer
nVariable speed strobe effect with 1-28 flashes per second
nPreset variable/random strobe and dimming pulse effect
n2.4" TFT LCD display (320*240pix) with 4 control buttons
nLCD display switch off automatically after 1 second
nReversible for LCD display
nPOWERCON connector IN/OUT
n3-Pin XLR connectors IN/OUT
nConstant temperature readout and management function
n2*1/4 turn fastening Omega Clamps (Adaptable vertically and horizontally)
n1* Safety attachment point

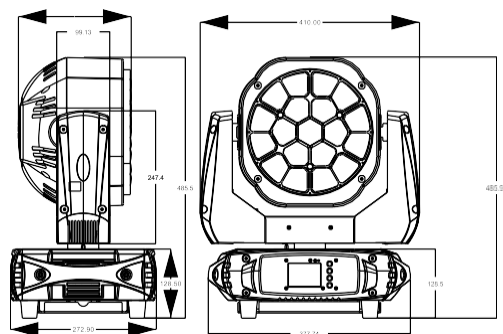

22	18	22	174..179	static scene30
			180..185	static scene31
			186..191	static scene32
			192..197	Multicolor static scene1
			198..203	Multicolor static scene2
			204..209	Multicolor static scene3
			210..215	Multicolor static scene4
			216..221	Multicolor static scene5
			222..227	Multicolor static scene6
			228..233	Multicolor static scene7
			234..239	Multicolor static scene8
			240..245	Multicolor static scene9
			246..251	Multicolor static scene10
			252..255	Multicolor static scene11
			Dynamic Patterns (If Patterns channel is in the interval 032 – 255)	
			000..023	No function
			024..137	Forward speed from zero speed to fast speed
			138..141	Stop movement
			142..255	Reverse speed from zero speed to fast speed
				Red in Pixel 1
			0..255	Red in pixel 1 saturation control (0-100%)
				Green in Pixel 1
			0..255	Green in pixel 1 saturation control (0-100%)
				Blue in Pixel 1
			0..255	Blue in pixel 1 saturation control(0-100%)
				White in pixel 1
			0..255	White in pixel 1 saturation control(0-100%)
				Red in pixel 2
			0..255	Red in pixel 2 saturation control(0-100%)
				Green in pixel 2
			0..255	Green in pixel 2 saturation control(0-100%)
				Blue in pixel 2
			0..255	Blue in pixel 2 saturation control(0-100%)
				White in pixel 2
			0..255	White in pixel 2 saturation control(0-100%)
				Red in Pixel 3
			0..255	Red in pixel 3 saturation control (0-100%)
				Green in pixel 3
			0..255	Green in pixel 3 saturation control(0-100%)
				Blue in pixel 3
			0..255	Blue in pixel 3 saturation control(0-100%)
				White in pixel 3
			0..255	White in pixel 3 saturation control(0-100%)
				Red in Pixel 4
			0..255	Red in pixel 4 saturation control (0-100%)
				Green in pixel 4
			0..255	Green in pixel 4 saturation control(0-100%)
				Blue in pixel 4
			0..255	Blue in pixel 4 saturation control(0-100%)
				White in pixel 4
			0..255	White in pixel 4 saturation control(0-100%)
				Red in Pixel 5
			0..255	White in pixel 5 saturation control (0-100%)
				Green in pixel 5
			0..255	Green in pixel 5 saturation control(0-100%)
				Blue in pixel 5
			0..255	Blue in pixel 5 saturation control(0-100%)
				White in pixel 5
			0..255	White in pixel 5 saturation control(0-100%)
				Red in Pixel 6
			0..255	White in pixel 6 saturation control (0-100%)
				Green in pixel 6
			0..255	Green in pixel 6 saturation control(0-100%)

21		17	21	137..141	Dynamic Scene22
				142..146	Dynamic Scene23
				147..151	Dynamic Scene24
				152..156	Dynamic Scene25
				157..161	Dynamic Scene26
				162..166	Dynamic Scene27
				167..171	Dynamic Scene28
				172..176	Dynamic Scene29
				177..181	Dynamic Scene30
				182..186	Dynamic Scene31
				187..191	Dynamic Scene32
				192..196	Multicolor Dynamic Scene1
				197..201	Multicolor Dynamic Scene2
				202..206	Multicolor Dynamic Scene3
				207..211	Multicolor Dynamic Scene4
				212..216	Multicolor Dynamic Scene5
				217..221	Multicolor Dynamic Scene6
				222..226	Multicolor Dynamic Scene7
				227..231	Multicolor Dynamic Scene8
				232..236	Multicolor Dynamic Scene9
				237..241	Multicolor Dynamic Scene10
				242..246	Multicolor Dynamic Scene11
				247..251	Multicolor Dynamic Scene12
				252..255	Multicolor Dynamic Scene13
22		18	22	Static patterns or patterns speed	
				Static Patterns	
				(If Patterns channel is in the interval 016 – 031)	
				000..005	static scene1
				006..011	static scene2
				012..017	static scene3
				018..023	static scene4
				024..029	static scene5
				030..035	static scene6
				036..041	static scene7
				042..047	static scene8
				048..053	static scene9
				054..059	static scene10
				060..065	static scene11
				066..071	static scene12
				072..075	static scene13
				078..083	static scene14
				084..089	static scene15
				090..095	static scene16
				096..101	static scene17
				102..107	static scene18
				108..113	static scene19
				114..119	static scene20
				120..125	static scene21
				126..131	static scene22
				132..137	static scene23
				138..143	static scene24
				144..149	static scene25
				150..155	static scene26
				156..161	static scene27
				162..167	static scene28
				168..173	static scene29

4. PHOTOMETRICS DIAGRAM

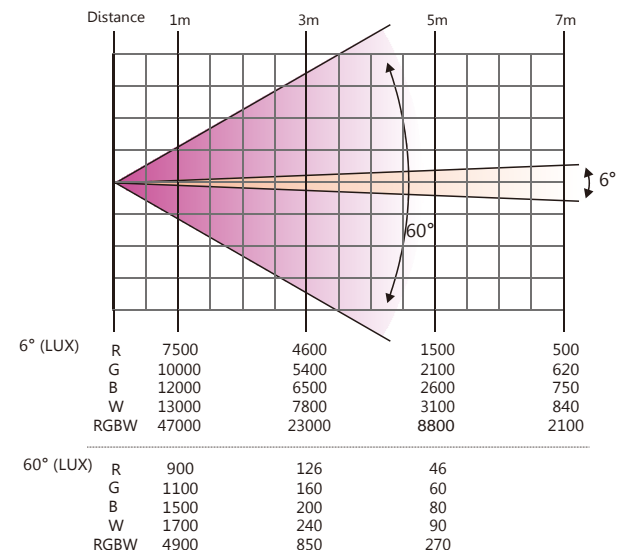

5. OPERATION INSTRUCTIONS

- Squareled Funky Bee Product for beam effect for on-site decoration purpose. Don't turn on the fixture if it's been through severe temperature difference like after transportation because it might damage the light due to the environment changes. So make sure to operate the fixture until it is in normal temperature.
- This light should be keep away from strong shaking during any transportation or movement.
- Don't pull up the light by only the head, or it might cause damages to the mechanical parts.
- Don't expose the fixture in overheat, moisture or environment with too much dust when installing it. And
- Don't lay any power cables on the floor. Or it might cause electronic shock to the people.
- Make sure the installation place is in good safety condition before installing the fixture.
- Make sure to put the safety chain and check whether the screws are screwed properly when installing the fixture.
- Make sure the lens are in good condition. It's recommended to replace the units if there are any damages or severe scratch.
- Make sure the fixture is operated by qualified personnel who knows the fixture before using.
- Keep the original packages if any second shipment is needed.
- Don't try to change the fixtures without any instruction by the manufacturer or the appointed repairing agencies.
- It is not in warranty range if there are any malfunctions from not following the user manual to operate or any illegal operation, like shock short circuit, electronic shock, lamp broke, etc.

Cautions:

Always use and install the supplied safety cable as a safety measure to prevent accidental damage and/or injury in the event the clamp fails.

Mounting points:

Be sure to complete all rigging and installation procedures before connecting the main power cord to the appropriate wall outlet.

Clamp Mounting:

Squarede Funky Bee provides a unique mounting bracket assembly that integrates the bottom of the base, and the safety cable rigging point in one unit (see the illustration below). When mounting this fixture to truss be sure to secure an appropriately rated clamp to the included omega bracket using a M10 screw fitted through the center hole of the "Hanging Kit". As an added safety measure be sure to attached at least one properly rated safety cable to the fixture using on of the safety cable rigging point integrated in the base assembly .

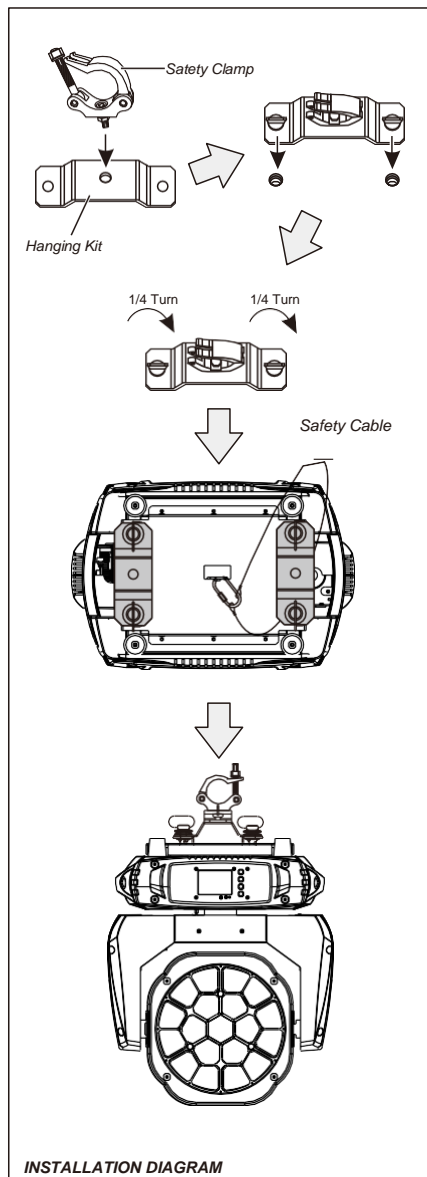

18		14	18		Foreground dimmer
				000..255	Foreground dimmer 0 – 100%.
19		15	19		Background color for patterns
					Choose Background color for Dynamic/Static Scene,no function for Multicolor Scene
				0..0	No Function
				1..13	Red
				14..27	Green
				28..41	Blue
				42..55	White
				56..69	Red+White
				70..83	Green+White
				84..97	Blue+White
				98..111	Green+Blue
				112..125	Red+Blue
				126..139	Red+Green
				140..153	Green+Blue+White
				154..167	Red+Blue+White
				168..181	Red+Green+White
				182..195	Red+Blue+Green+White
				196..202	2700K
				203..209	3200K
				210..216	3500K
				217..223	5000K
				224..230	5500K
				231..237	6000K
				238..244	6500K
				245..251	7000K
252..255	8000K				
20		16	20		Background dimmer
				000..255	Background dimmer 0 – 100%.
21		17	21		Patterns
				000..015	No function
				016..031	Static patterns
				032..036	Dynamic Scene1
				037..041	Dynamic Scene2
				042..046	Dynamic Scene3
				047..051	Dynamic Scene4
				052..056	Dynamic Scene5
				057..061	Dynamic Scene6
				062..066	Dynamic Scene7
				067..071	Dynamic Scene8
				072..076	Dynamic Scene9
				077..081	Dynamic Scene10
				082..086	Dynamic Scene11
				087..091	Dynamic Scene12
				092..096	Dynamic Scene13
				097..101	Dynamic Scene14
				102..106	Dynamic Scene15
				107..111	Dynamic Scene16
				112..116	Dynamic Scene17
				117..121	Dynamic Scene18
				122..126	Dynamic Scene19
				127..131	Dynamic Scene20
				132..136	Dynamic Scene21

8.MENU OPERATIONS

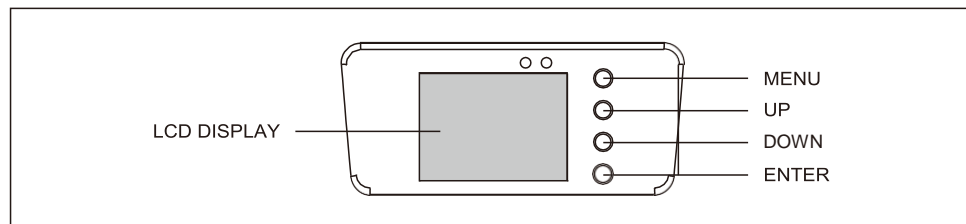

MENU				Description
Function Mode	Dmx Address	A001~AXXX		<i>DMX address setting</i>
	Channel Mode	CH23 MODE		<i>23 Channel Mode</i>
		CH17 MODE		<i>17 Channel Mode</i>
		CH95 MODE		<i>95 Channel Mode</i>
		CH99 MODE		<i>99 Channel Mode</i>
Option	Auto Run	Internal Program1~8	Master/Alone	<i>Auto run</i>
	Music Control	Internal Program1~8	Master/Alone	<i>Sound Control</i>
	Reset Default	Yes/No		<i>Reset Default</i>
	Signal Set	Wire DMX		<i>Wire DMX</i>
		Wireless DMX		<i>Wireless DMX</i>
		Act WDMX & Out		<i>Act WDMX & Out</i>
	Pan / Tilt	Reverse Pan (On/Off)		<i>Reverse Pan</i>
		Reverse Tilt (On/Off)		<i>Reverse Tilt</i>
		Select Pan 630°/540°/360°		<i>Pan Degree,default is 540°</i>
		Select Tilt 270°/180°/90°		<i>Tilt Degree,default is 270°</i>
	UI SET	Mic SEN 0~99%		<i>Sensitivity Setting</i>
		OFF Signal Mode (On/Off)		<i>OFF at original status and ON at reset status when no DMX signal</i>
Information	Temperature	XXX°C/°F		<i>Current Temperature</i>
	Software Version	V1.0~V9.9		<i>Software Version</i>
Manual Control	Reset	Total Reset		<i>Total Reset</i>
		Pan/Tilt Reset		<i>Pan/Tilt Reset</i>
		Zoom Reset		<i>Zoom Reset</i>
Advanced (Access Code 088)	Channel	PAN=XXX.....		<i>Manual Control Channel</i>
		PAN=XXX.....		<i>Calibration(Code:088)</i>

9.DMX PROTOCOL

Mode/Channel				Value	Function
23	17	95	99		
1	1	1	1	0..255	Pan
					PAN Movement
2	2	2	2	0..255	Pan -fine
					Fine control of Pan movement
3	3	3	3	0..255	Tilt
					Tilt Movement
4	4	4	4	0..255	Tilt -fine
					Fine control of Tilt movement
5	5	5	5		Speed pan/tile
				0..225	max to min speed
				226..235	blackout by movement
6	6	6	6	236..255	no function
					Dimmer
				0..255	Dimmer 0%...100%
7	7	7	7		Shutter
				0..31	Shutter closed
				32..63	shutter open
				64..95	Strobe effect slow to fast
				96..127	shutter open
				128..159	Pulse-effect in sequences slow to fast
				160..191	shutter open
				192..223	Random strobe effect slow to fast
8	8		8	224..255	shutter open
					Red
				0..255	0-100% Red dimmer from dark to bright
9	9		9	0..255	Green
					0-100% Green dimmer from dark to bright
10	10		10	0..255	Blue
					0-100% Blue dimmer from dark to bright
11	11		11	0..255	White
					0-100% White dimmer from dark to bright
12	12	8	12	0..255	Zoom
					In(near)to out(far)
13	13	9	13		Zoom Rotation
				0..3	Zoom rotation stop
				4..127	Forwards rotation from fast to slow
				128..131	Zoom rotation stop
14	14	10	14	132..255	Backwards rotation from slow to fast
					Virtual color
				0..0	No Function
				1..13	Red
				14..27	Green
				28..41	Blue
				42..55	White
				56..69	Red+White
				70..83	Green+White
				84..97	Blue+White
				98..111	Green+Blue
				112..125	Red+Blue
				126..139	Red+Green



Das Lichttechnikhaus Vertriebs GmbH

Rudolf-Diesel-Str. 3, D-89312 Günzburg

Telefon +49 (0) 82 21 207 98-0

Fax +49 (0) 82 21 207 98-69

E-Mail info@lth-gmbh.de

Web www.lth-gmbh.de